



Flat 14, Brandon Villas Jacobs Wells Road, Clifton, Bristol, BS8 1EU

Offers In Excess Of £215,000

Hollis Morgan - A modern purpose built apartment located in a desirable position moments from Clifton Village

Description

The property occupies the upper floors of a cleverly designed modern development, with the external finish inspired by the period townhouses of Cliftonwood. Internally the apartment has been carefully configured to utilise the 485 Sq Ft footprint with a light and airy kitchen/lounge area positioned at the front of the apartment, the kitchen comprises a range of matching wall base unit, stainless steel sink, tiled splash backs and integrated appliances.

The lounge area benefits from engineered wood flooring and large double glazed windows. Making up the remaining accommodation is a large storage cupboard with plumbing for appliances, double bedroom and fully tiled three piece bathroom suite.

Location

Jacobs Wells Road is located on the East Side of Clifton within a few yards of QEH School with excellent access to Clifton Village, The Harbourside and the Triangle whilst The University of Bristol and Royal Infirmary are both within one mile.

Clifton and the surrounding areas, with its Victorian and Georgian architecture, are amongst the most sought after locations in the City. The area offers charm alongside excellent amenities with independent shops, boutiques, cafes, bars and restaurants to be found on both Whiteladies Road and Clifton Village including Clifton Down shopping Centre. The Downs offers four hundred acres of green public space whilst Brunel's Clifton Suspension Bridge provides a gateway to the Ashton Court Estate with its woodlands, mountain bike trails and walks whilst there is excellent access to the exciting Harbourside district, the City Centre and Temple Meads.

Rental Information

Please refer to agent.

Tenure/Management Information

Management fee - £110.00

Tenure - Leasehold residue of 999 years



Flat 14

Approx. 44.8 sq. metres (482.2 sq. feet)

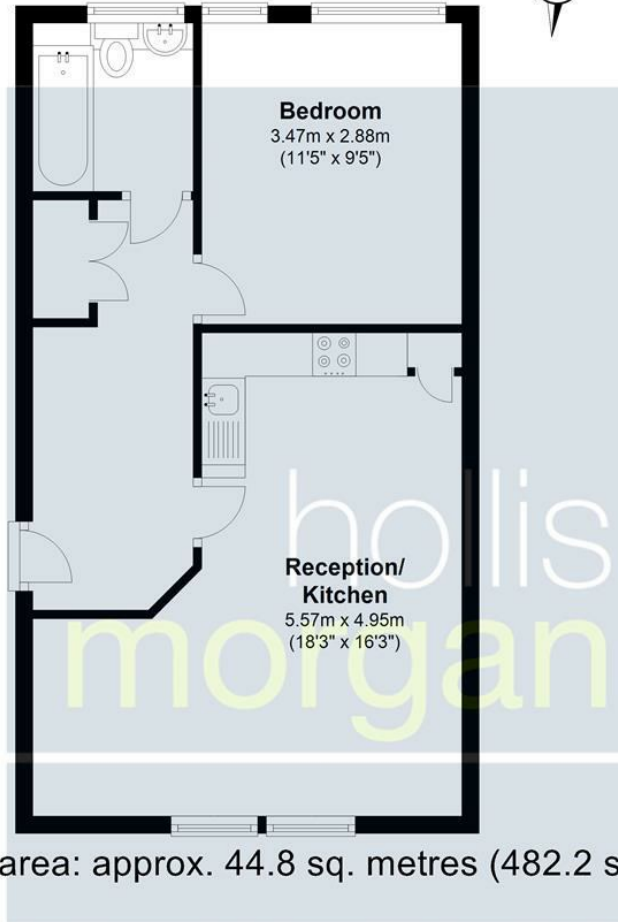

Total area: approx. 44.8 sq. metres (482.2 sq. feet)

Illustration for identification purposes only, measurements are approximate, not to scale.

Floorplan Produced by Westcountry EPC
Plan produced using PlanUp.

e-mail: post@hollismorgan.co.uk www.hollismorgan.co.uk

9 Waterloo Street, Clifton, Bristol BS8 4BT. Telephone: 0117 973 65 65

Hollis Morgan Property Limited, registered in England, registered 7275716. Registered address, 5 Upper Belgrave Road, Clifton, Bristol BS8 2XQ

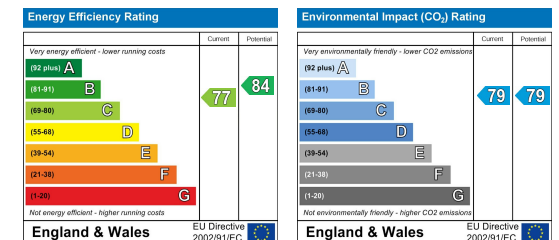

hollis
morgan
